



## **Compton Creek Stormwater and Urban Runoff Capture and Reuse Project at Earvin Magic Johnson Park**

### **○ Project Scope**

The project will divert urban and stormwater runoff from nearby unincorporated communities, into a water treatment system for landscape irrigation reuse. The project will utilize the existing southern lake for temporary storage of 7 acre-feet, will incorporate a conveyance system for use in a future phase to divert flows to the existing northern lake for an additional storage of 5 acre-feet, will enhance the park's amenities by incorporating biofiltration gardens, children's play area, Low-Impact-Development features, and educational signage.

### **○ Project Benefits**

The project will improve the quality of our rivers and ocean, increase local water supply through the use of an alternate source of water, provide community enhancement, and provide educational and outreach opportunities.

### **○ Project Location**

- Earvin Magic Johnson Park (905 E El Segundo Blvd, Los Angeles, CA)
  - El Segundo Blvd and Wadsworth Ave

### **○ Cost Estimate**

- Total Project Cost of Phase 1A: \$50M
  - Cost for Stormwater Capture and Reuse Components: \$21M
    - County General Fund: \$10.1M
    - Flood Control District: \$10.9M
  - Cost for Other Components: \$29M

### **○ Tentative Milestone Schedule**

- Currently – Design Phase
- Summer 2018 – Award Construction Contract
- Spring 2020 – Construction Closeout



### Site Layout

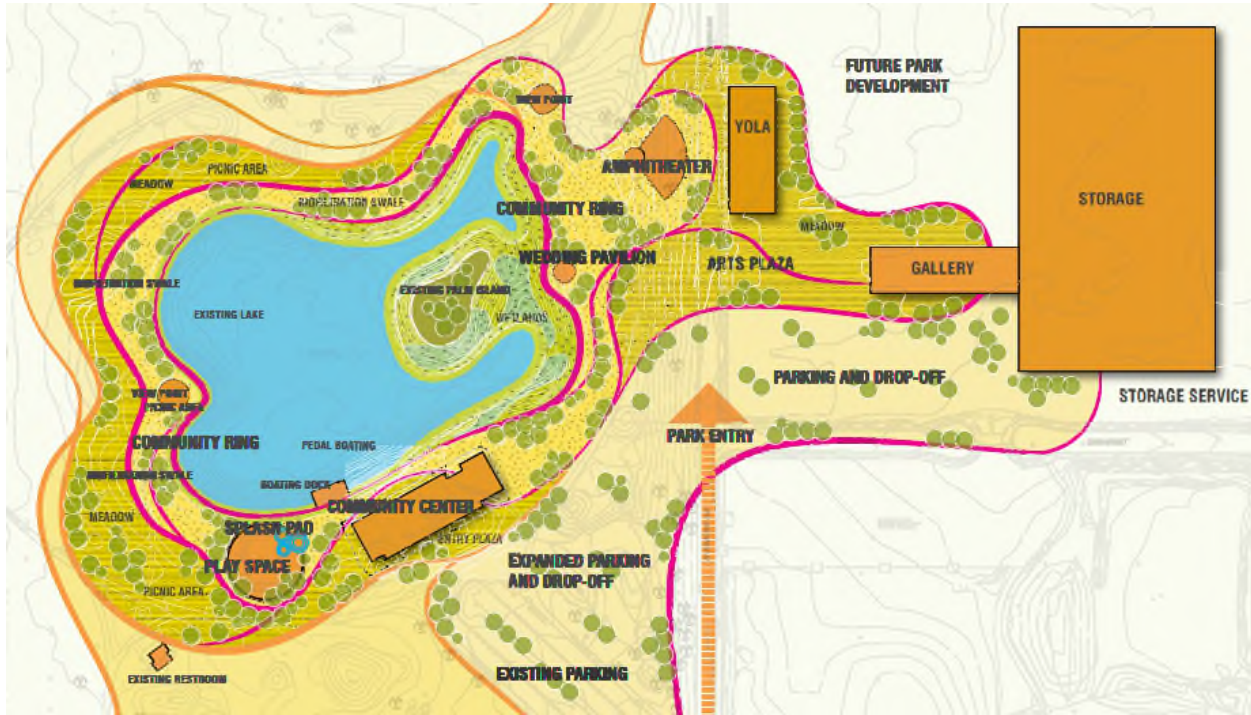

### General Vicinity Map

